

# The WAILERS ft. JULIAN JUNIOR MARVIN

## Hospitality Rider

The purchaser agrees to provide, at no cost to the Artist or Artist the following refreshments and at the directions and times as set out herein: Dinner or Per Diems Buyout of \$50 USD per person shall be given to the Tour Manager for 12 people for everyday including travel days. We understand that not exactly everything may be available.

Dressing Room: Please have Cups/Plates and silverware etc. for dressing room and take out. A constant supply of hot mint tea, hot water and coffee maintained throughout the duration of the engagement, plus one (1) jar honey. - Two (2) cases Smart Bottled water or Fiji bottled water (12 oz. Room Temperature).

**(Absolutely NO Dasani or Aquafina)**

**Please)** - One (12 pack of Red Stripe Beer - One (1) 12 pack of Sprite — One (1) selection of Nantucket Nectar fruit juices - One (1) six-pack of ginger beer - One (12 pack) Bai Antioxidant Infusion Variety Pack - One (1) six-packs of assorted Odwalla fruit and vegetable juice. Carrot, etc. - Two (2) loaves of bread. One (1) each of white, wheat.

One (1) assorted vegetable platter. - One (1) Meat Platter (**White meat - Chicken and turkey Breast Only. PLEASE NO PORK, BACON OR HAM. Must be kept refrigerated**). - One (1) jar of creamy peanut butter. - One (1) jar of grape jelly. - Two (2) boxes Natures Valley oats & honey granola bars. - Two (2) bags of Cashew nuts and Two (2) bags Pistachio nuts - Assortment of potato chips and Doritos with Salsa Dip - One (1) Box of Throat Coat Tea - One (1) bag of Halls Vitamin C cough drops. - A selection of uncut fruits: lemons, limes, apples, oranges, grapes, bananas and plums. —

Fifteen (15) fresh/washed clean white medium sized face towels. **NO BAR TOWELS ACCEPTED.**

The Purchaser agrees furthermore NOT to serve any fast food and all refreshments are to be presented in a clean and proper manner, with tablecloths, cutlery and proper plates. All hospitality must be served at the venue unless otherwise directed by the Artist or Artist Representative.

Any questions please contact Mr. Mark Miller  
[markmillerthelegendarywailers@gmail.com](mailto:markmillerthelegendarywailers@gmail.com)

# THE WAILERS featuring JULIAN JUNIOR MARVIN

\*SPARE WIRELESS\*

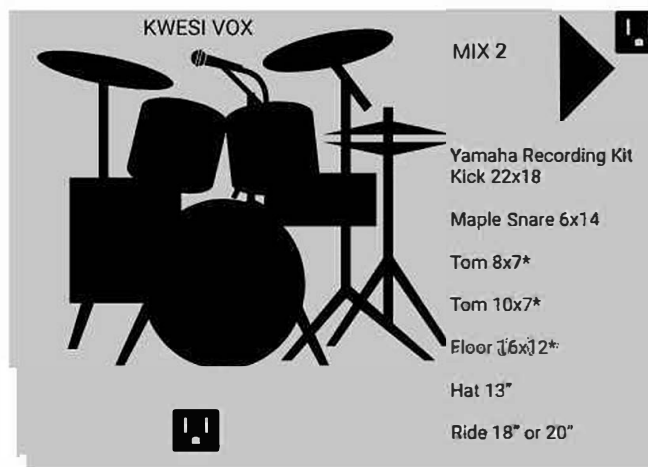
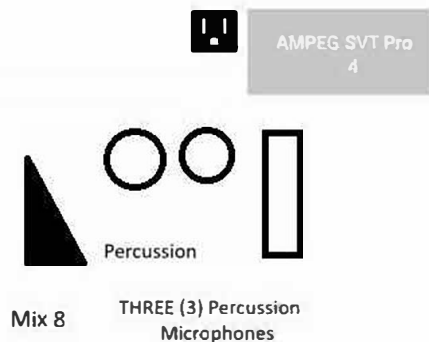

GUITAR : 3

BASS GUITAR

Roland JC-120

Lead Guitar 1

MIX 3

MIX 7

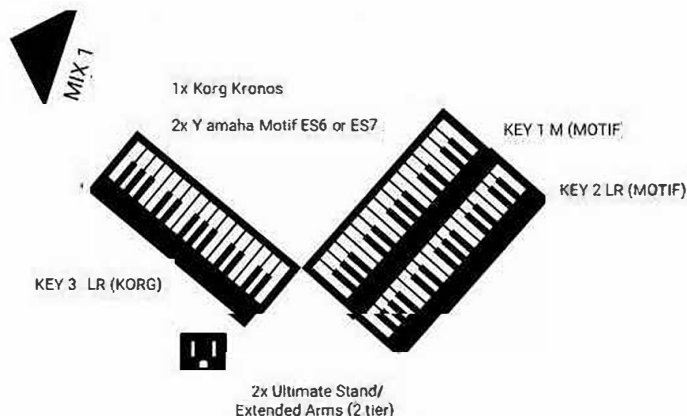

ERICA VOX

MIX 6

JR VOX

MIX 4

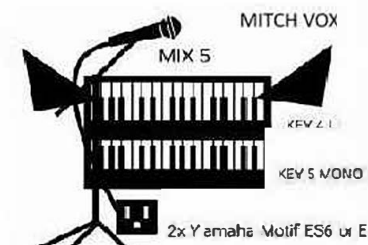

Ultimate Stand/Extended Arms



GUITAR  
Des

MIX 7

SF 8

2024

AC 120v Edison QUAD Box

***THE WAILERS***  
***Featuring JULIAN JUNIOR MARVIN***  
**BACKLINE RIDER 2025**

**BASS** - TWO (2) AMPEG SVT-PRO 4 or higher Bass Amplifier Head - TWO (2) AMPEG Bass Cabinet 8 x 10" - TWO (1) 25' 1/4" Instrument Cables - THREE (3) Speakers cables

**DRUMS** - Yamaha Recording Kit - Kick 22"x18" - Maple Snare 6"x14" - \*Tom 8"x7" - \*Tom 10"x7" - \*Floor 16"x12" - Hat 13" or 14" - Ride 18" or 20" - 2x Crash 15" & 16" - Roland SPD-SX (Sabian Cymbals/Hats) - Yamaha or DW Stands (DW9000 or DW5000) - TWO (2) Sets of 5A Pro Mark drum sticks – ONE adequate size DRUM RISER + (1) Drum Carpet

**KEYBOARDS** - **ABSOLUTELY NO WEIGHTED KEYS PLEASE** - FOUR (4) Yamaha Motif ES6 + ONE (1) Korg Kronos + ONE (1) Laptop Stand, plus FOUR (4) Ultimate keyboard Stands with 2 tiers (**EXTENDED TIERS ARE REQUIRED**) – Sufficient Instrument Cables – FOUR (4) Sustain Pedals

**GUITAR** - ONE Fender Stratocaster w/009 strings (SPARE) - ONE (1) Roland JC-120 Guitar Amps + ONE (1) Twin Reverbs - TWO (2) 12' Guitar Cables - TWO (2) 25' Guitar Cables - FIVE (5) Tall Hercules Guitar Stands (1 Bass / 4 Guitars) - ONE (1) QUAD 110v Edison AC Box (*DOWNSTAGE CENTER*)

**PERCUSSION:** 1 set of Congas with Conga stand(s), 1 Cymbal stand, 1 Percussion rack

**MISC** - SIX (6) 110v Edison AC QUAD Boxes - TWO (2) 220v - 110v STEP DOWN Transformers (Only in Non-USA Countries) with American Plug receptacles (Edison).

***PLEASE NOTE WE HAVE TWO (2) KEYBOARD PLAYERS***

Any questions or request for substitution(s)

CONTACT

MMCo / Mr. MARK MILLER

Tel: + 33 6 42 50 87 93

Email: markmillertheegendarywailers@gmail.com

Mr. Pete Melton (Production Manager)

Tel: + 1 770 778 4510

Email: pete.e.melton@gmail.com

**THE WAILERS**  
**featuring JULIAN JUNIOR MARVIN**  
**CONTRACT PERFORMANCE RIDER 2025**

**BILLING**

The name of the Artist shall be utilized as 100% Headline Artist and not be associated with any product service or sponsor without previous agreement by the Artist and in writing. The Purchaser shall not commit the Artist to any personal appearances, interviews, or other types of promotion without the express prior written consent of the Artist or its representative.

No other act may appear on the same program without the prior written approval of the Artist.

If the facility has a marquee, then THE WAILERS featuring JULIAN JUNIOR MARVIN must appear on the marquee on each night of the Performance. If the Performance is sold out the marquee shall display "Sold Out" all day on the day of the Engagement.

No image of Bob Marley is to be used at any time for promotion relating to the THE WAILERS featuring JULIAN JUNIOR MARVIN engagement.

It is crucial that current photos of the "THE WAILERS featuring JULIAN JUNIOR MARVIN" are used in ALL forms of print advertising. No other photos are to be utilized. Happy Family Productions shall provide Artist approved photos and press materials.

---

**REPRODUCTION OF ENGAGEMENT**

Except as expressly provided in the Agreement, no portion of the Performance, this Engagement, or any activity of Artist, may be filmed, recorded, broadcast, or reproduced by Purchaser or any third party. Artist reserves all such rights, including the authorized designee(s) access to the Engagement and the right to free and open movement in and about the Engagement with any recording device so approved by Artist. No television or video projection systems shall be used or broadcast from the Engagement without Artist's prior written consent.

---

**LICENSES, TAXES, ETC.**

Purchaser shall at its own sole cost obtain all licenses, permits, certificates, insurance, authorizations, and/or any and all other requisite approval(s) from any and all union guilds or other entities having jurisdiction with respect to the engagement(s) and further shall comply with and fulfill all terms and conditions and covenants as set-out herein.

PURCHASER AGREES TO FULLY PAY ANY and ALL TAX DUE TO ANY TAXING AUTHORITY FOR MONEYS EARNED AS A RESULT OF AND IN CONNECTION WITH SAID ENGAGEMENT(S). IT IS FURTHERMORE UNDERSTOOD AND AGREED BY BOTH PARTIES THAT ABSOLUTELY NO DEDUCTION(S) WHATSOEVER FOR SUCH TAX PAID SHALL BE TAKEN FROM THE CONTRACT FEE.

**DAMAGE, LOSS, INSURANCE**

It is agreed and understood that absolutely no responsibility whatsoever for public liability rests with the Artist or Artist Representative. Nor shall the Artist or Artist Representative be held responsible for any death, accident, or injury howsoever caused or incurred by the Purchaser or its employees during the term of this contract. The Purchaser accepts sole responsibility for any and all damage caused to the Venue, its equipment, personnel or furnishings. The Purchaser shall retain responsibility for any damage to, or loss of, the Artist and its personal equipment, property, vehicle and baggage during the term of this contract when in the control of Purchaser shall make any necessary compensation payments prior to the conclusion of the engagement.

## FORCE MAJEURE

In the event of illness, incapacity, accident, act of God, riot, labor dispute, epidemics, failure of transportation or any other act beyond the control of the Artist or Artist Representative, the Artist shall not be required to perform the engagement herein contracted, shall be paid in full as per the contract and shall not be held liable in any way whatsoever for any loss of any kind suffered to the Purchaser.

## HOSPITALITY RIDER

### PLEASE NO PORK, BACON OR HAM

The purchaser agrees to provide, at no cost to the Artist or Artist the following refreshments and at the directions and times as set out herein:

Dinner / Per Diems ~ Buyout of \$50 USD per person shall be given to the Tour Manager for 9 people for everyday including travel days or days off at event.

Dressing Room:

Please have Cups/Plates and silverware etc. for dressing room and take out.

A constant supply of hot mint tea, hot water and coffee maintained throughout the duration of the engagement, plus one (1) jar honey.

- Two (2) cases Fiji bottled water (12 oz. or more). (**Absolutely NO Dasani or Aquafina Please**)
  - One (1) selection of Nantucket Nectar fresh Fruit Juices
  - One (1) Six-pack of ginger beer
  - One (12 pack) Bai Antioxidant Infusion Variety Pack
  - One (1) Six-pack of assorted Odwalla fruit and vegetable juice. Carrot, etc.
  - Two (2) loaves of bread. One (1) each of white, wheat.
  - One (1) assorted vegetable platter.
  - One (1) Freshly sliced Meat Platter  
(White meat - Chicken and turkey Breast Only. No Pork. Must be kept refrigerated).
  - One (1) jar of creamy peanut butter+ One (1) jar of grape jelly.
  - Two (2) boxes Natures Valley oats & honey granola bars.
  - Two (2) bags of cashew nuts.+ Two (2) bags of pistachio nuts.
  - Assortment of potato chips and Doritos with Salsa Dip
  - One (1) Box of Throat Coat Tea
  - One (1) bag of Halls Vitamin C cough drops.
  - A selection of uncut fruits: lemons, limes, apples, oranges, grapes, bananas and plums.
  - One (1) 12 pack of Sprite
- Fifteen (15) fresh/washed clean. white medium-size face towels. **PLEASE NO BAR TOWELS.**

The Purchaser agrees furthermore NOT to serve any fast food and all refreshments are to be presented in a clean and proper manner, with tablecloths, cutlery and proper plates. All hospitality must be served at the venue unless otherwise directed by the Artist or Artist Representative.

# TECHNICAL

---

## LABOR/EQUIPMENT REQUIREMENTS

- All labor calls will be advanced with and confirmed by the Tour Manager.
  - All loaders and stagehands MUST be experienced, able-bodied, sober, wearing proper footwear and carrying all necessary tools.
  - All labor calls will be advanced with and confirmed by the Tour Manager.
  - We usually travel with a front of house tech but need a monitor engineer supplied. This info will be confirmed in preliminary phone conversations.
- 

## LOAD-IN

- Four (4) experienced stagehands
- One (1) qualified electrician who is fully conversant with the venue's power supply, and who shall remain present at the venue for the duration of the engagement. This electrician shall, at the direction of the Artists road crew, connect, assist and disconnect all electrical supplies.

SOUND/LIGHTS: TBA  
BACKLINE: TBA  
SOUNDCHECK: TBA  
SHOW: TBA

---

## LOAD-OUT\

- Four (4) experienced stagehands

One (1) qualified electrician who is fully conversant with the venue's power supply, and who shall remain present at the venue for the duration of the engagement. This electrician shall, at the direction of the Artists road crew, connect, assist and disconnect all electrical supplies.

## STAGING REQUIREMENTS

*See stage plot*

## MIX POSITION

*Off Center Right or Left (NO DIRECT CENTER POSITION PLEASE)*

POWER REQUIREMENTS *FOUR (4) Step Down Transformers 220/110V AC Edison (Outside U.S.)*

---

## SECURITY

The Purchaser shall guarantee proper security at all times to ensure the safety of the Artist, their personnel, equipment, personal possessions and vehicles from the time of arrival until departure. Particular attention must be directed to the front of the stage, with one static security personnel at each entrance to dressing room area(s).

**No unauthorized persons shall be allowed access to the backstage area.**

## SOUND REINFORCEMENT REQUIREMENTS

The Purchaser agrees to provide at no cost to the Artist a first-class sound reinforcement system comprising of the following:

### FRONT-OF-HOUSE SYSTEM

Fully functional, professional, quality, 48-channel console required. Free of buzzes, hum, excessive noise, crackles, clicks and pops. The console must feature 4-band fully parametric EQ and continually variable HPF on every input channel.

Preferred FOH Consoles Yamaha PM10 or  
M7CLv2/Midas M32 (Small Venue's under 500 capacity)

If the preferred consoles are not available Management/ Production must be notified in advance. the artist's production team reserve's the right to reject any gear that is below industry standards. Sound reinforcement must be of a suitable size and quantity to deliver clean, undistorted, full-range sound at a volume of 110dBA to every seat / viewing area in the venue. \*Note that this is a reggae show and as such requires substantial sub-bass energy. Aux-fed subs much preferred.

Preferred Reinforcement systems: D&B, Meyer, L'Acoustics.  
Please supply a switched shout system between FOH and monitors, with the capability of routing the FOH microphone to the stage monitors.

---

## MONITOR SYSTEM

The band requires an independent monitor system provided with an English-speaking technician who has full knowledge of the system for the assistance of the band's monitor engineer. Please position the monitor control Stage Left with good sight lines to the whole band.

Absolutely no non-essential personnel onstage or around the monitor console during the bands show please. A fully functional, professional quality 48-channel console is required, free of buzzes, hum, excessive noise, crackles, clicks and pops. The console must feature at least 16 auxiliary sends with individually switchable on/off and pre/post, 4-band fully parametric EQ and continually variable HPF on every input channel.

MONITOR CONSOLES: Yamaha PM 10 or Midas M32 Please ensure the firmware is updated to the current version

The following monitor speakers on- stage:

- TWELVE (12) identical, bi-amp/ Full range floor monitors.

Cue Wedge:

- Please provide one (1) cue wedge at monitor control position, identical to the on-stage wedges.

Drum-Fill:

- One (1) 3/4-way, active, full-range drum monitor with subwoofer.

- Two (2) 3/4-way, active, full-range side fills with subwoofer.

- All channels go to FOH and monitors.

- Snare microphones must be freestanding and not attached to snare drum.

**Preferred monitors D&B, L'Acoustics, Meyer**

# THE WAILERS ft. JULIAN JUNIOR MARVIN BACKLINE REQUIREMENTS

## BASS

- TWO (2) AMPEG SVT-PRO 4 or higher Bass Amplifier Head
- TWO (2) AMPEG Bass Cabinet 8 x 10" or
- ONE (1) AMPEG Bass Cabinet 4 X10" AND ONE AMPEG 1 x 15"
- TWO (1) 25' 1/4" Instrument Cables
- THREE (3) Speakers cables

## DRUMS

Yamaha Recording Kit

- Kick 22"x18"
- Maple Snare 6"x14"
- \*Tom 8"x7"+ \*Tom 10"x7"
- \*Floor 16"x12"
- Hat 13" or 14"
- Ride Cymbal 18" or 20" PLUS 2x Crash Cymbals 15" & 16"
- (Sabian Cymbals/Hats)
- Yamaha or DW Stands (DW9000 or DW5000)
- TWO (2) Sets of 5A Pro Mark drum sticks
- ONE (1) Drum Carpet

## KEYBOARDS

*ABSOLUTELY NO WEIGHTED KEYS PLEASE*

- FOUR (4) Yamaha Motif ES6
- ONE (1) Korg Kronos
- THREE (3) Ultimate keyboard stands with 2 tiers (**EXTENDED TIERS ARE REQUIRED**)
- SIX (6) 10' Instrument Cables
- THREE (3) Sustain Pedals

## GUITAR

- ONE (1) Fender Stratocaster w/009 strings (SPARE)
- ONE (1) Roland JC-120 Guitar Amps
- TWO (2) Twin Reverbs
- FOUR (4) x 12' Guitar Cables PLUS FOUR (4) x 25' Guitar Cables
- FIVE (5) Tall Hercules Guitar Stands (1 Bass / 4 Guitars)
- ONE (1) QUAD 110v Edison AC Box (*DOWNSTAGE CENTER*)

## MISC

- SIX (6) 110v Edison AC QUAD Boxes
  - TWO (2) 220v - 110v STEP DOWN Transformers with American Plug receptacles (Edison)
-



---

## LIGHTING REQUIREMENTS

The Purchaser agrees to supply at no cost to the Artist a first-class lighting rig comprising of the following:

- One (1) Lighting board to match or exceed lighting requirements listed
- Thirty (30) 1K par 64 (very narrow for downstage truss)
- Thirty (30) 1K par 64 (very narrow for upstage truss)
- Eight (8) Leiko Instruments (on downstage truss)
- Two (2) Blinders (For upstage/crowd)
- Two (2) Super Trouper or equivalent Spotlights
- Two (2) Spotlight Operators
- One (1) Attentive Console Operator

### **GUIDELINES FOR LIGHTING DIRECTORS - IMPORTANT**

NO TOTAL BLACKOUTS at ANY TIME  
(Especially Between Songs)

**ABSOLUTELY NO DRY ICE OR SMOKE MACHINES TO BE UTILIZED DURING PERFORMANCE!!!**

Please keep focused specials always on at a moderate level so no matter what wash or scene is displayed, the band is still well lit. The following positions should be set: SL vocal, center vocal (2 specials crossbeam), SR keys, drums, bass, and SL Keys. Use of bright scenes and whites is very important. Use colors such as yellows, soft no colors, etc. Our main concern is that the overall stage be completely bright with overdramatic lighting effects. The use of backlighting is preferred for a moderated source of onstage light. White light (no gel) is an acceptable method of raising the overall stage scene and is an excellent means to brighten the area. Musicians must be able to see from one side of the stage to the other. No artist should be in the shadows. They need to be able to visually communicate at all times. The above said, these guidelines are written for the means to insure a great & authentic performance for the audience and artists alike.

*Please Do Not Deviate From These Guidelines  
Use Discretion*

# STAGE PLOT / THE WAILERS featuring JULIAN JUNIOR MARVIN

## THE LEGENDARY WAILERS featuring JULIAN JUNIOR MARVIN

\*SPARE WIRELESS\*

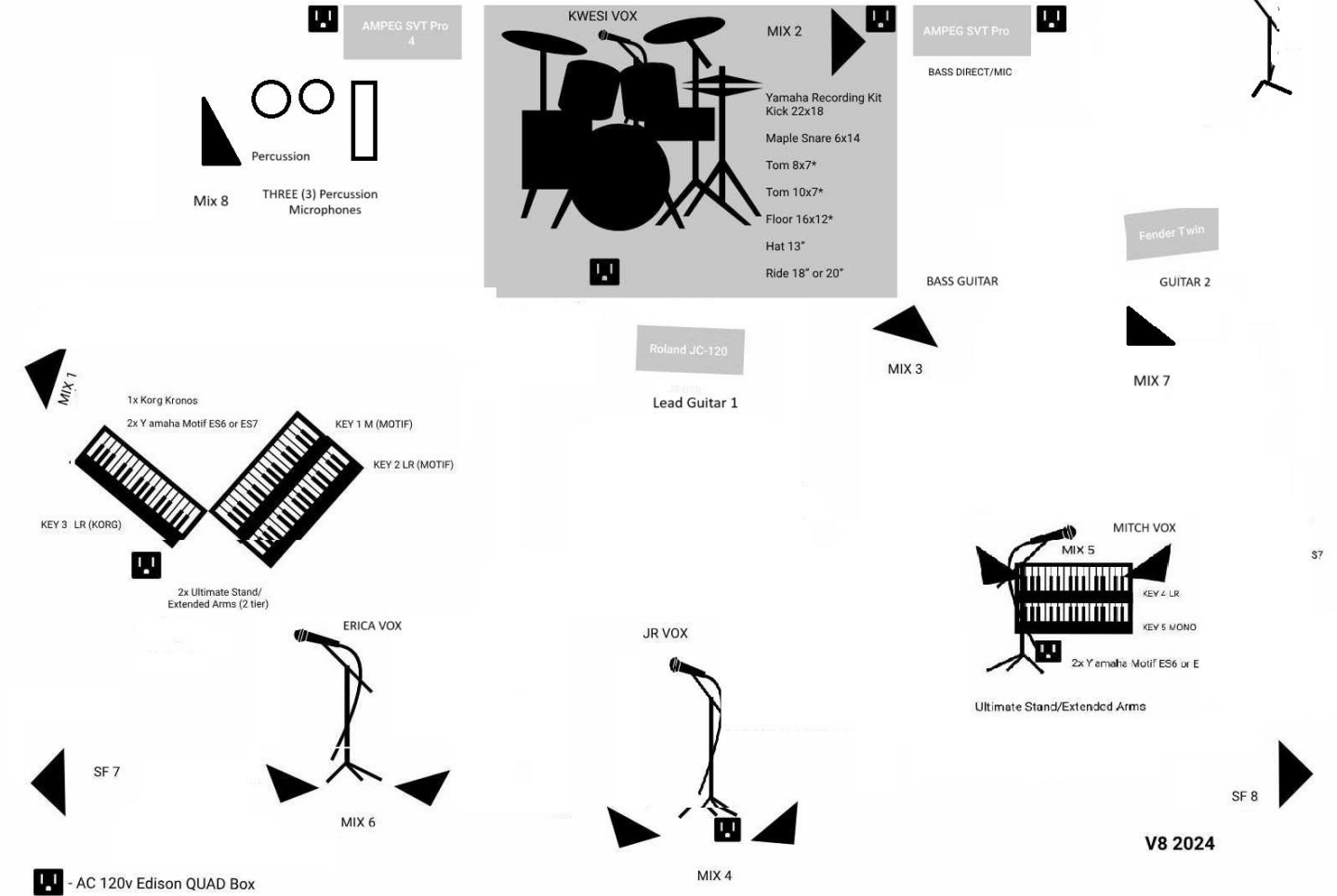

- 1 - KIK IN (Shure SM91)
- 2 - KIK OUT (AKG D-112 or RE-20)
- 3 - SNR T (BETA 57 OR 609)
- 4 - SNR B (609 OR SM 57)
- 5 - HAT (RODE NT5 or SM81)
- 6 - TOM (609 or SM57)
- 7 - TOM (609 or SM57)
- 8 - FLR (609 or SM57)
- 9 - OH L (RODE NT5 or SM81)
- 10 - OH R (RODE NT5 or SM81)
- 11 - PERC 1 (SM57)
- 12 - PERC 2 (SM57)
- 13 - PERC 3 (SM57)
- 14 - BASS DIRECT (BSS or RADIAL DI)
- 15 - BASS MIC (AKG D-112 or RE-20)
- 16- JR GTR 1 (409 or SM57)
- 17 - GTR 2 (409 or SM57)
- 18 - KEY 1 **MONO** (BSS or RADIAL DI)
- 19 - KEY 2 **MONO** (BSS or RADIAL DI)
- 20 - KEY 3 **MONO** (BSS or RADIAL DI)
- 21 - KEY 4 **MONO** (BSS or RADIAL DI)
- 22 - KEY 5 **MONO** (BSS or RADIAL DI)
- 23 - ERICA VOX (BETA 58)
- 24 - JR VOX (SM58)
- 25 - DESI VOX BETA 58)
- 26 - SPARE RF VOX (BETA 58)

---

## THE WAILERS featuring JULIAN JUNIOR MARVIN

PERSONNEL:

NAME	POSITION	ROOM TYPE	CITY
Julian Junior Marvin	Vocals / Lead Guitar	Suite	Springfield VA
Isaac Kouao	Drums / Vocals	Single	District of Columbia
Earl Michelin	Keys 1	Single	Baltimore MD
Erica Newell-Stewart	Backing Vocals	Single	Atlanta GA
Ricci Kerr	Backing Vocals	Single	Ft. Lauderdale FL
Ian Carlington Johnson	Keys 2	Single	Palm Beach FL
Stephen Samuels	Bass Guitar	Single	Baltimore MD
Rory Kerr	FOH ENG	Single	Ft. Lauderdale FL
Justin Karlinch	Monitor Engineer	Single	Virginia
Ricky Richardson	Guitar 2	Single	Virginia
David Kerr	Vocals	Single	Ft. Lauderdale
Mark Miller	Co. Director	Business Class	Nice, France

Any questions contact Mr. Mark Miller  
Email: [markmillerthelegendarywailers@gmail.com](mailto:markmillerthelegendarywailers@gmail.com)  
Tel: +33 6 42 50 87 93

# THE WAILERS featuring JULIAN JUNIOR MARVIN

*For all performance questions please contact:*

**Mr. Mark Miller**

[markmillerthelegendarywailers@gmail.com](mailto:markmillerthelegendarywailers@gmail.com)

Tel: +33 6 42 50 87 93

and

**Mr. JUNIOR MARVIN**

[juniormarvin09@gmail.com](mailto:juniormarvin09@gmail.com)

+1 703 447 6993